

Hyperion™

PDAO - Cylindrical Shape

without Hub

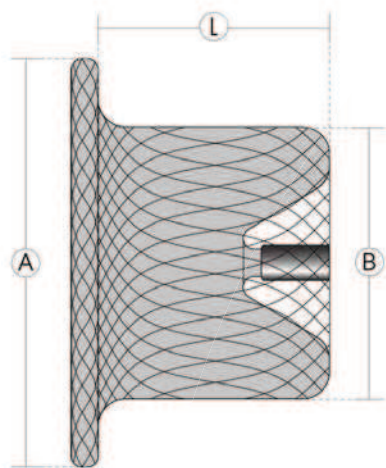

Product Information

Features

- 72 pre-oxidised Nitinol wires
- Cylindrical shape
- Aligned retention skirt
- Without hub design
- Screw connection

Sizing

- 14 sizes
- Ø 5 to 22 mm

Benefits

- Functional elasticity
- Enhanced shape memory
- Secure positioning
- Anatomical deployment
- Safe attachment/detachment

- High bio-compatibility
- Fast endothelialisation
- Minimised nickel release

Delivery

The Hyperion™ PDA Occluder is compatible with the Orbit-V Delivery System

(A) : Retention Skirt Ø

(B) : Pulmonary Artery Ø

(C) : Descending Aorta Ø

(L) : Length of Waist

Ordering Information

Hyperion™ PDAO - Cylindrical Shape without Hub

Catalogue #	Descending Aorta Ø (mm) ③	Pulmonary Artery Ø (mm) ②	Retention Skirt Ø (mm) ①	Length of Waist (mm) ④	≥ Orbit-V Delivery System
C-PDA-SW-I 05	5.0	5.0	8.0	4.5	6F
C-PDA-SW-I 06	6.0	6.0	9.0	5.0	7F
C-PDA-SW-I 07	7.0	7.0	10.0	6.0	7F
C-PDA-SW-I 08	8.0	8.0	11.0	6.0	7F
C-PDA-SW-I 09	9.0	9.0	12.0	6.5	8F
C-PDA-SW-I 10	10.0	10.0	14.0	7.0	8F
C-PDA-SW-I 11	11.0	11.0	15.0	7.5	9F
C-PDA-SW-I 12	12.0	12.0	16.0	8.0	9F
C-PDA-SW-I 13	13.0	13.0	17.0	8.5	10F
C-PDA-SW-I 14	14.0	14.0	18.0	9.0	10F
C-PDA-SW-I 16	16.0	16.0	21.0	10.0	10F
C-PDA-SW-I 18	18.0	18.0	23.0	10.5	12F
C-PDA-SW-I 20	20.0	20.0	25.0	12.0	12F
C-PDA-SW-I 22	22.0	22.0 </td <td>27.0</td> <td>12.0</td> <td>12F</td>	27.0	12.0	12F

- ① : Retention Skirt Ø
- ② : Pulmonary Artery Ø
- ③ : Descending Aorta Ø
- ④ : Length of Waist

